

CF PARTITION

INSULATED METAL WALL PANEL



The CF Partition insulated metal panel is designed to be the most economical choice for interior partition applications. The lightly corrugated profile provides added strength on both faces and ensures symmetry from the exterior to the interior of the building, and between rooms.

LOCK & GROOVE SYSTEM

PANEL

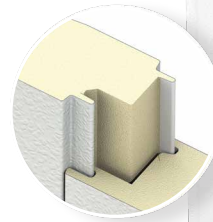

PANEL PROFILE

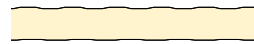

PRODUCT SPECIFICATIONS

WIDTH 44½"

THICKNESS 2", 2½", 2¾", 3", 4", 5", 6"

LENGTH 8'-0" to 53'-0"

EXTERIOR FACE Stucco embossed, G-90 galvanized and/or AZ-50 aluminum-zinc coated steel in 26, 24 and 22 Ga. Optional smooth, unembossed finish

INTERIOR FACE Mesa profile, Light Mesa profile, stucco-embossed, G-90 galvanized and/or AZ-50 aluminum-zinc coated steel in 26, 24 and 22 Ga.

JOINT Offset double tongue-and-groove

EXTERIOR PROFILE Mesa nominal ⅛" deep
Light Mesa nominal ¼" deep

INTERIOR PROFILE Mesa nominal ⅛" deep
Light Mesa nominal ¼" deep

CORE Foamed-in-place, zero ozone depleting (zero ODP) polyurethane, FM Class 1 approval

FASTENING Through fastened at the top and bottom of the panel

THERMAL VALUES K-factor, Btu in/ft² hr. °F @ 75° F (24° C) mean core temperature = 0.140. K-factor, Btu in/ft² hr. °F @ 40° F (4° C) mean core temperature = 0.126.

U-FACTORS AND R-VALUES

U-FACTOR (BTU/h-ft²·°F)

PANEL WIDTH: 44½"

	75°
2"	0.0706
2½"	0.0516
3"	0.0424
4"	0.0324
5"	0.0264
6"	0.0224

PANEL WIDTH: 44½"

	40°
2"	0.0669
2½"	0.0491
3"	0.0401
4"	0.0305
5"	0.0248
6"	0.0210

R-VALUE (h-ft²·°F/BTU)

PANEL WIDTH: 44½"

	75°
2"	14.16
2½"	19.38
3"	23.58
4"	30.86
5"	37.88
6"	44.64

PANEL WIDTH: 44½"

	40°
2"	14.95
2½"	20.37
3"	24.94
4"	32.79
5"	40.32
6"	47.62

FM Approved Class 1 with no height restrictions.

*Available only from Nevada plant.

TESTING: CF PARTITION INSULATED METAL WALL PANEL

TEST/APPROVAL	TEST METHOD	TEST TITLE	RESULTS
Fire US	ASTM E84	Surface Burning Characteristics of Building Materials	Flame spread <25, smoke developed <450
	ASTM E119	Fire Tests of Building Construction Materials	One hour non-load bearing rating with two layers of Type X Gypsum Vertical or horizontal installation
	FM 4880	Class 1 Fire Rating of Insulated Wall, Ceiling and Roof Panels	Product approved
	NFPA 286	Fire Tests for Evaluating Contribution of Wall and Ceiling Finish to Roof Fire Growth	Test specimen met the criteria of the IBC Section 803.1.2.1
Fire Canada	CAN/ULC S101	Fire Endurance Tests of Building Construction and Materials	One hour non-load bearing fire rating with two layers of Type X Gypsum
	CAN/ULC S101	Fire Endurance Tests of Building Construction and Materials	Meets 15 minute stay-in-place requirements
	CAN/ULC S102	Surface Burning Characteristics of Building Materials and Assemblies	Meets the National Building Code of Canada requirements
	CAN/ULC S138	Fire Growth of Insulated Building Panels in a Full-Scale Room Configuration	Met the criteria of the standard
Structural	ASTM E72	Strength Tests of Panels for Building Construction	See Load Chart
	ASTM E1592	Structural Performance of Metal Roof and Siding Systems by Uniform Static Air Pressure Differences	See Load Chart
Thermal Performance	ASTM C518	Steady-State Thermal Transmission Properties by Means of the Heat-Flow Meter Apparatus	K-Factor of 0.126 BTU.in/hr.ft ² .°F at 40° F mean core K-Factor of 0.14 BTU.in/hr.ft ² .°F at 75° F mean core
	ASTM C1363	Thermal Performance of Building Materials and Envelope Assemblies	See Thermal Performance Guide
Air Infiltration	ASTM E283	Rate of Air Leakage Through Curtain Walls Under Specified Pressure Differences	<0.01 cfm/ft ² at 20 psf Vertical or horizontal installation
Water Infiltration	ASTM E331	Water Penetration of Exterior Walls by Uniform Static Air Pressure Differences	No uncontrolled leakage when tested to a static pressure of 20 psf Vertical or horizontal installation

Descriptions and specifications contained herein were in effect at the time this publication was approved for printing. In a continuing effort to refine and improve products, Metallic reserves the right to discontinue products at any time or change specifications and/or designs without incurring obligation. To ensure you have the latest information available, please inquire or visit our website at metallic.com.